

Drain: Sifon FONTA URBAN M125 250X250 iesire verticala Dn110 (33352513-5)

33352513-5

250 mm
LENGTH

110 mm
HEIGHT

250 mm
WIDTH



USAGE:

The ductile iron trap for sewage is a useful, pragmatic, and modern solution used for collecting rainwater and directing it toward underground sewage lines.

QUALITY CONDITIONS:

Compliant with SR EN 1253-1:2015.

ADVANTAGES:

- Attractive design
- Watertightness
- Thermal and mechanical resistance
- Use in residential areas or private homes
- Long lifespan
- Anti-slip

LIFESPAN:

50 years - with proper adherence to installation, storage, and operation instructions.

INSTALLATION

It can be installed in private premises, yards, industrial halls, paved paths, or in areas with light traffic resistance, underground or subterranean garages/parking lots, etc.

! For efficient installation, we recommend using the G12M29C sealant. It is used for sealing trenches, pipes, and drainage systems.



- Cure time: 24 hours for 2-3 mm thickness
- Operating temperature: -10° C to +40° C
- Storage conditions: Store in a ventilated space at low temperatures

BASE sealant, construction products, 310 ml tube (G12M29-C).

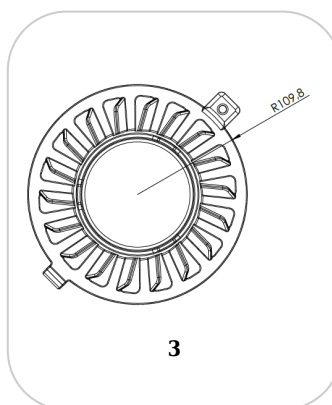
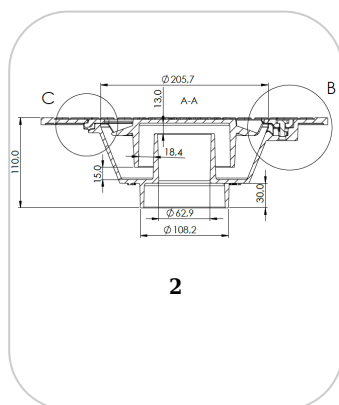
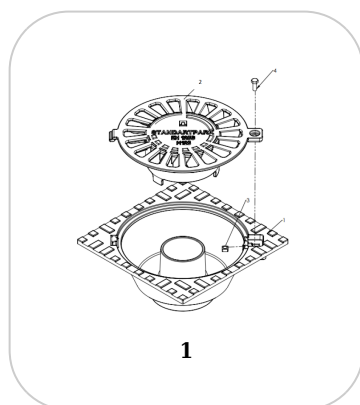

CHARACTERISTICS

Product name	Sifon FONTA URBAN M125 250X250 iesire verticala Dn110 (33352513-5)
Product code	33352513-5
EAN code	6426282034535
Product category	Sifoane Fonta
Brand	Drain
Weight	6.40 kg
Stock availability	Stockable
Length, mm	250
Width, mm	250
Height (H), mm	110
Interior diameter / Clear opening (mm)	110
Exterior diameter (mm)	205
Load class	M125
Product Material	Cast Iron
Fastening System	Screw
Producer	