

Technical liquid's Tank TT-20 (S 1:25)

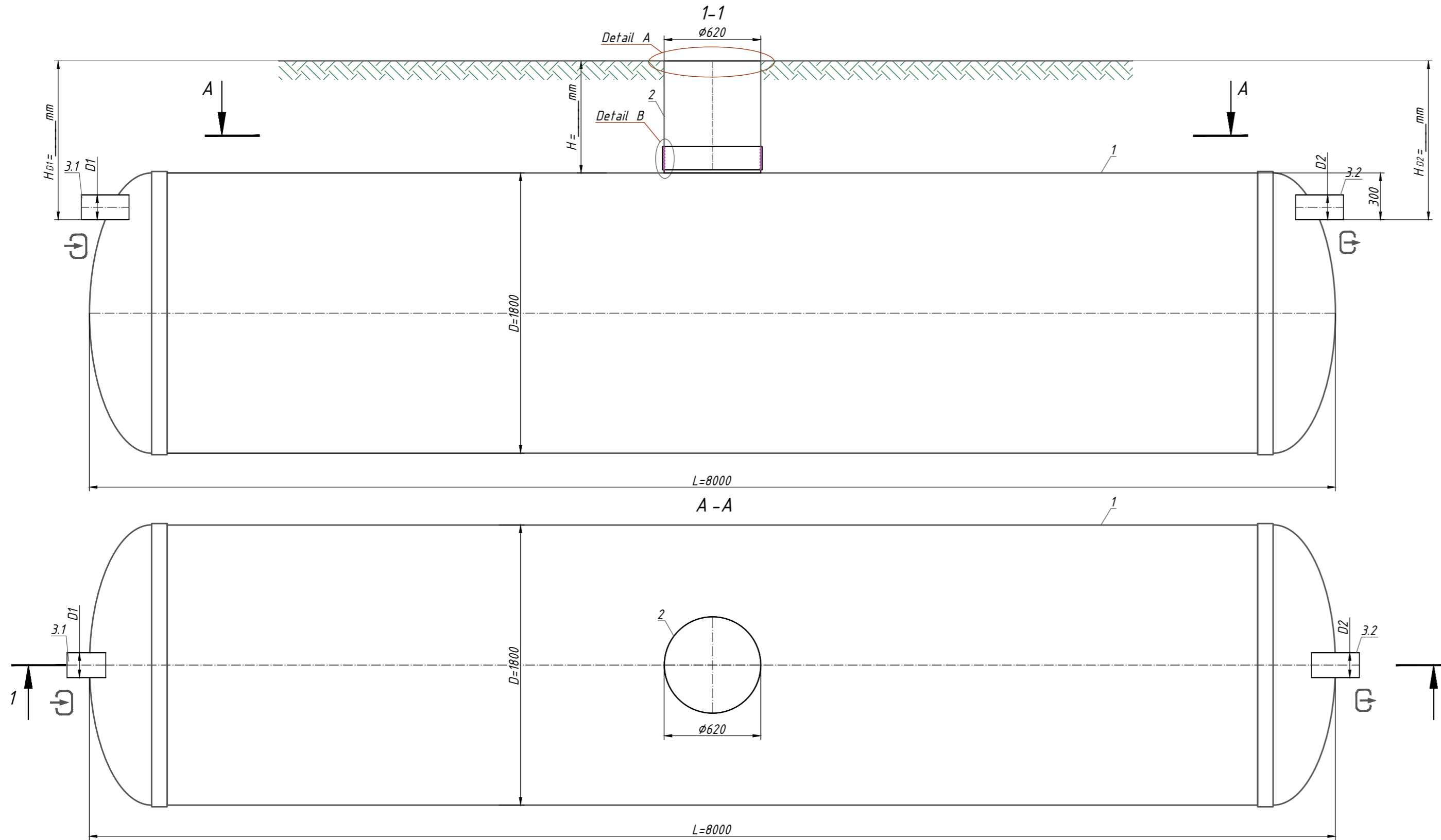

Note:

*H-depth of the inlet connection, mm (in standard equipment H up to 2000 mm). H take a multiple of 50mm.

When filling the manhole A.1-the overall height of the product is less than 200mm; A.2-the total height of the product is bigger than 100mm.

**The product is shipped according to Standard Equipment(Tabl.1), unless otherwise specified in the Additional (Tabl.2). The full configuration of the product is agreed with the manager.

***The manufacturer has the right to make constructive and pattern changes that do not worsen the characteristics of the product as a whole

Permissible deviation during production of products is 1-3%.

Additional Information: _____

A -Manhole design*

B -Fixing the manhole with the tank***

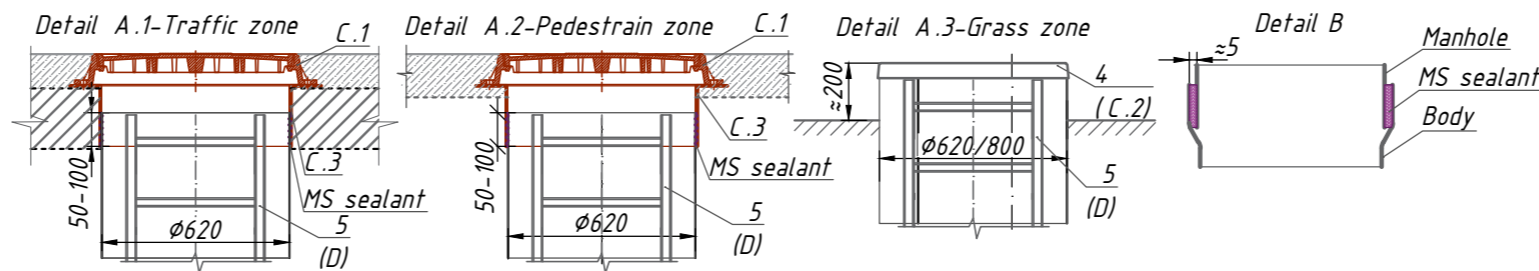

Specification of materials and equipment. Standard equipment ** (Tabl.1)

Pos.	Identification	Name	Q-ty	Mass pc. kg	Note
1	Vodaland	Technical liquid's Tank Vodaland Tank Technical-20, volume 20m ³ , horizontal, fiberglass, D=1800 mm L=8000 mm	1		compl.
2		Inspection manhole 620	1		compl.
3.1,3.2	D1-Inlet pipe D2-Outlet pipe	Pipe PVC SN4 6160	2		compl.

**The product is shipped according to Standard Equipment(Tabl.1), unless otherwise specified in the Additional (Tabl.2)

Additional equipment (Tabl.2)

Pos.	Identification	Name			Note	
A, B	D1-Inlet pipe/D2-Outlet pipe:	<input type="checkbox"/> <input type="checkbox"/>	<input type="checkbox"/>	<input type="checkbox"/>		
		Pipework connection: D1, D2:	Socket end	<input type="checkbox"/>	<input type="checkbox"/>	
		Smooth end	<input type="checkbox"/>	<input type="checkbox"/>		
	Diameter D pipes D1,D2:	An.:	<input type="checkbox"/>	<input type="checkbox"/>		
		690	<input type="checkbox"/>	<input type="checkbox"/>		
		160	<input type="checkbox"/>	<input type="checkbox"/>		
An.:		<input type="checkbox"/>	<input type="checkbox"/>			
C	Manhole design (see A.1, A.2)					
	C.1 Cover:	Garden plastic	<input type="checkbox"/>	<input type="checkbox"/>		
		Load class A15	<input type="checkbox"/>	<input type="checkbox"/>		
		Load class C250	<input type="checkbox"/>	<input type="checkbox"/>		
		Load class D400	<input type="checkbox"/>	<input type="checkbox"/>		
	C.2	Fiberglass cover 620	<input type="checkbox"/>	<input type="checkbox"/>		
		C.3 Fiberglass adaptor plate 620, h=200mm	<input type="checkbox"/>	<input type="checkbox"/>		
		None	<input type="checkbox"/>	<input type="checkbox"/>		
		An.:	<input type="checkbox"/>	<input type="checkbox"/>		
	D	D.Universal ladder	Aluminum	<input type="checkbox"/>	<input type="checkbox"/>	
s/s	<input type="checkbox"/>	<input type="checkbox"/>				
E	E.Fastening	Belt fastening	<input type="checkbox"/>	<input type="checkbox"/>		
F	F.Ventilation	Vent.pipe PVC SN4 6110 with fungus	<input type="checkbox"/>	<input type="checkbox"/>		
G	G.Additional equipment	An.:	<input type="checkbox"/>	<input type="checkbox"/>		
			<input type="checkbox"/>	<input type="checkbox"/>		

Rev.	Q-ty	Sh.	Ndoc.	Sign.	Date	Stage	Sheet	Sheets

Technical liquid's Tank TT-20

